

**FOR LEASE - 380 MacNaughton Ave., Moncton  
10,800 TO 21,800SF plus offices available**

- Just off Elmwood Drive with easy access to TransCanada Highway
- Natural Gas heating in warehouse. Sprinkler System
- 2,200 SF Expandable Office space readily available - Multiple options up to 21,000SF available
- Large semi-paved yard with security fencing
- 24 ft ceilings for great storage capacity

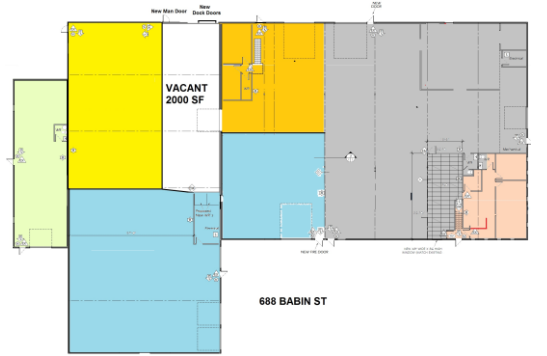
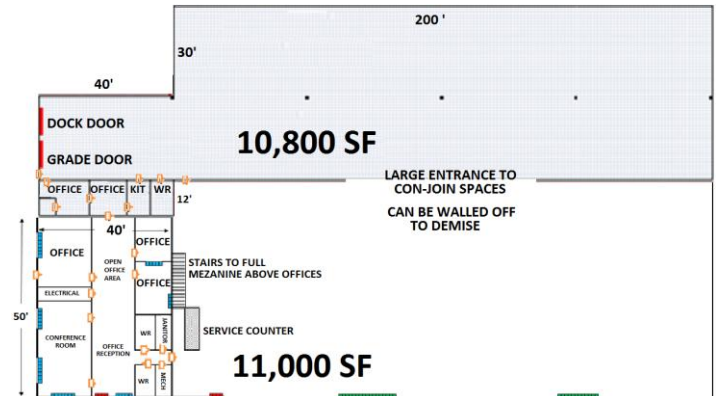

**688 Babin St., Dieppe  
2,000SF Available**

- Sprinkler System throughout
- Ample parking
- Natural gas heat
- Double insulated roof
- Drive In Door
- 18-22ft ceilings

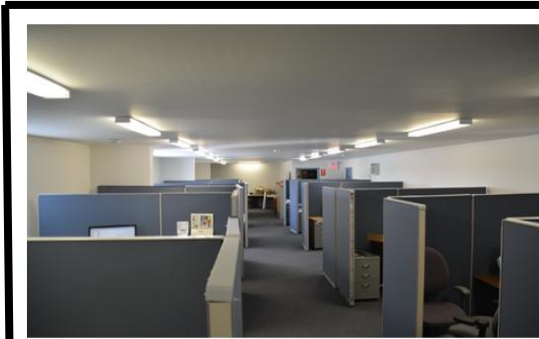

**663 Malenfant., Dieppe  
2,000SF Available**

- Office Space
- Ample parking
- Split Cooling / Heating
- Cubicles Available
- Great lease Rates
- Available Immediately

**Why Choose Us?**

Flexible Leasing Options  
First Rate Customer Service  
Client Consulted Layouts  
Professional & Helpful Staff  
24-7 Emergency Services  
Locally Owned & Operated  
Bilingual Service



Contact Cathy Sweet

506 869 0942  
cathy@comztar.com  
www.comztar.com



@comztar



/comztar



/comztar