

17 Somers Ave, Moncton, NB

16,000SF Available

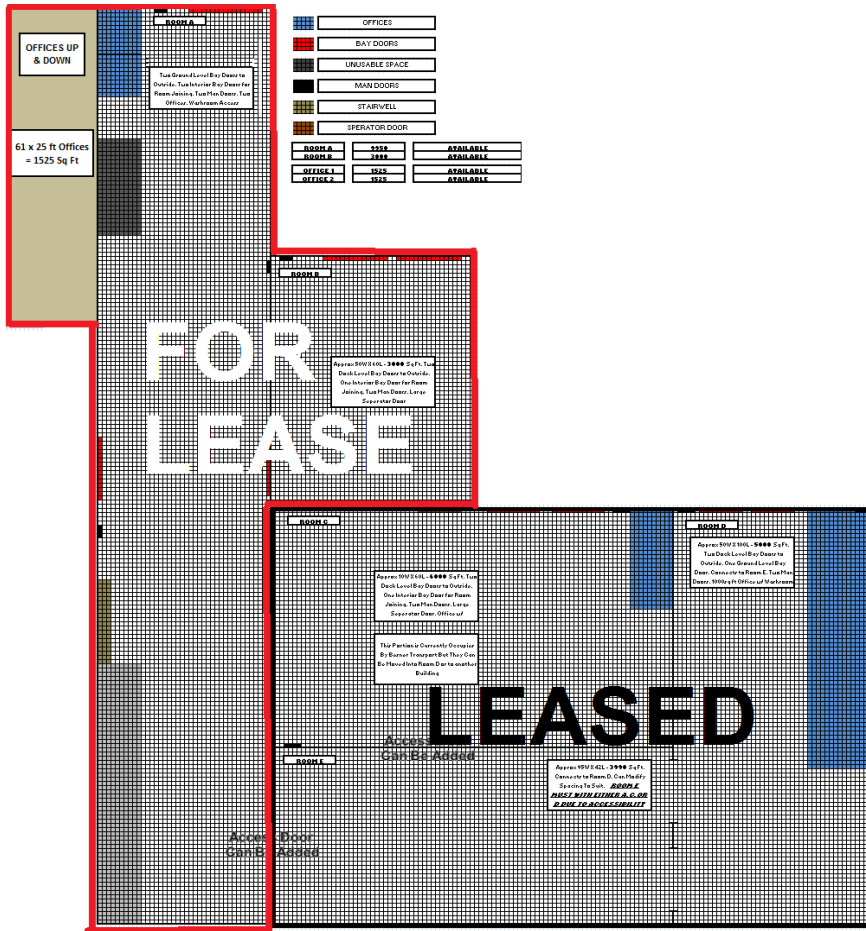

16,000 SF TOTAL

Property Features & Benefits

- Total 16,000 SF available
- Excellent Frontage on Caledonia Road
- Highway visibility on back of building.
- Fantastic Location in Caledonia Industrial Park!
- Easy access to the TransCanada Hwy, and just off Elmwood Drive.
- Ample Office space readily available
- Large semi-paved yard
- High Ceilings for great storage capacity
- 26 ft to 30 ft ceilings
- Sprinkler system

Why Choose Us?
 Flexible Leasing Options
 First Rate Customer Service
 Client Consulted Layouts
 Professional & Helpful Staff
 24-7 Emergency Services
 Locally Owned & Operated
 Bilingual Service



Contact Cathy Sweet
(506) 869-0942
 cathy@comztar.com
 www.comztar.com



BROKER PROTECTED