

47 Industrial St., Dieppe, NB



2,000SF up to 18,800SF – Multiple Demises Available(See Page 2)

Property Highlights

- Single or multi-tenant building in the Dieppe Industrial Park
- Building features well finished offices and a large open warehouse along with three already demised additional bays, each with their own loading
- 16'-18' ceilings
- Numerous grade and dock loading doors
- Ample on-site parking

Location

- Located in the Dieppe Industrial Park close to the Greater Moncton International Airport
- Easy access to Highway 15 and the Trans Canada Highway and downtown Dieppe

Details

Taxes (2016)	\$30,041.06
PID	01003359
Zoning	Industrial Park

18,800 sf Industrial Building

11,200 sf Demisable Including 1200 sf Office
Three Spaces Also Demisable
3200 SF - 2400 SF - 2000 SF

- Property formally was a manufacturing facility that was fitted with multiple power options.
- Building is fully sprinklered with a ventilated area for dust and paint.
- In addition building is set up with pneumatic piping and drops.
- Three tractor trailer size front doors with one of the same size at the direct rear.
- Radiant tube natural gas heating throughout.
- Excellent lease rates and low operating costs



Why Choose Us?

Flexible Leasing Options
First Rate Customer Service
Client Consulted Layouts
Professional & Helpful Staff
24-7 Emergency Services
Locally Owned & Operated
Bilingual Service



Contact Cathy Sweet

506 869 0942
cathy@comztar.com
www.comztar.com



@comztar



/comztar



/comztar

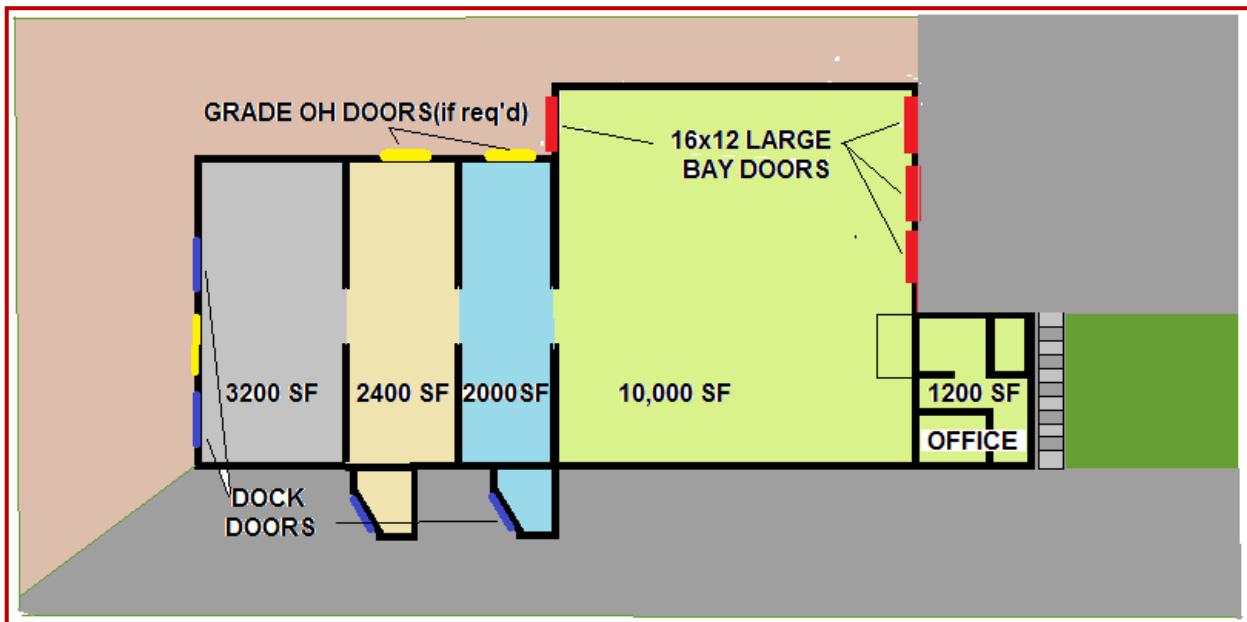

Why Choose Us?

- Flexible Leasing Options
- First Rate Customer Service
- Client Consulted Layouts
- Professional & Helpful Staff
- 24-7 Emergency Services
- Locally Owned & Operated
- Bilingual Service



Contact Cathy Sweet

506 869 0942
cathy@comztar.com
www.comztar.com



@comztar



/comztar



/comztar