

FOR LEASE - 380 MacNaughton Ave., Moncton
10,800 TO 21,800SF plus offices available

- Just off Elmwood Drive with easy access to TransCanada Highway
- Natural Gas heating in warehouse. Sprinkler System
- 2,200 SF Expandable Office space readily available - Multiple options up to 21,000SF available
- Large semi-paved yard with security fencing
- 24 ft ceilings for great storage capacity

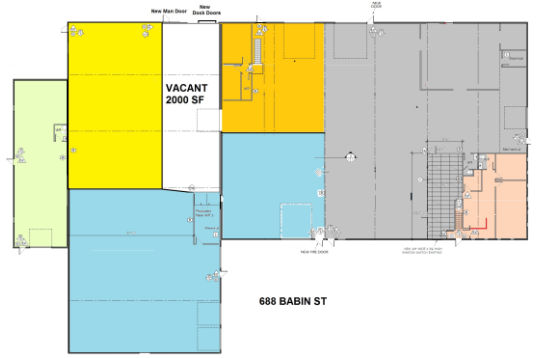
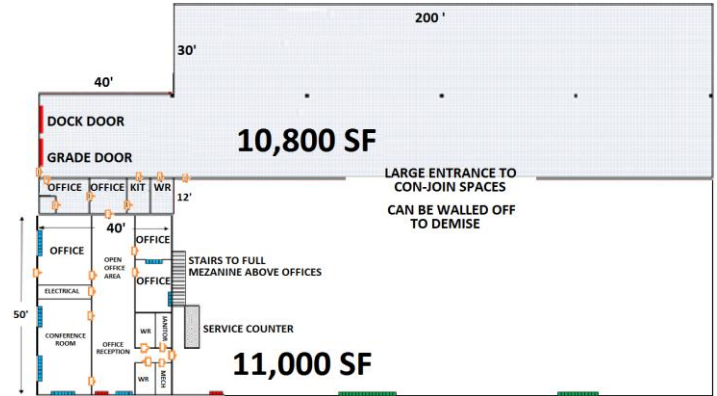

688 Babin St., Dieppe
2,000SF Available

- Sprinkler System throughout
- Ample parking
- Natural gas heat
- Double insulated roof
- Drive In Door
- 18-22ft ceilings

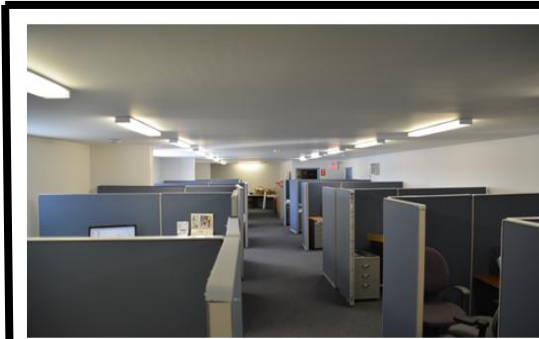

663 Malenfant., Dieppe
2,000SF Available

- Office Space
- Ample parking
- Split Cooling / Heating
- Cubicles Available
- Great lease Rates
- Available Immediately

Why Choose Us?

Flexible Leasing Options
First Rate Customer Service
Client Consulted Layouts
Professional & Helpful Staff
24-7 Emergency Services
Locally Owned & Operated
Bilingual Service



Contact Cathy Sweet

506 869 0942
cathy@comztar.com
www.comztar.com

