

161 Caledonia Road, Moncton, NB

Up to 12,000SF Available

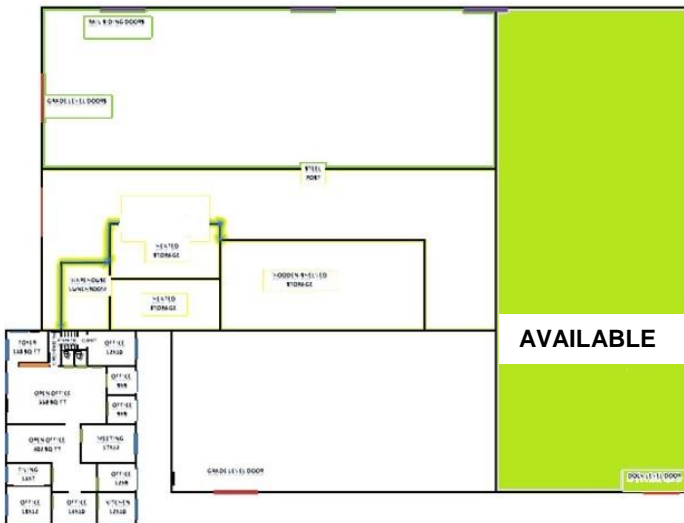

7,000 to 12,000 sf warehouse

Property Features:

- Fantastic location in Caledonia Industrial Park
- Close to Costco
- Easy access to the TCH
- 22' Clear
- One dock door
- Natural gas heating
- Insulated ceiling
- High visibility from Trans-Canada-Highway
- Great lease rates
- Below average CAM rates

Why Choose Us?
Flexible Leasing Options
First Rate Customer Service
Client Consulted Layouts
Professional & Helpful Staff
24-7 Emergency Services
Locally Owned & Operated
Bilingual Service



Contact Cathy Sweet

506 869 0942

cathy@comztar.com

www.comztar.com



@comztar



/comztar



/comztar