

**47 Industrial St., Dieppe, NB**  
2,130 SF Available

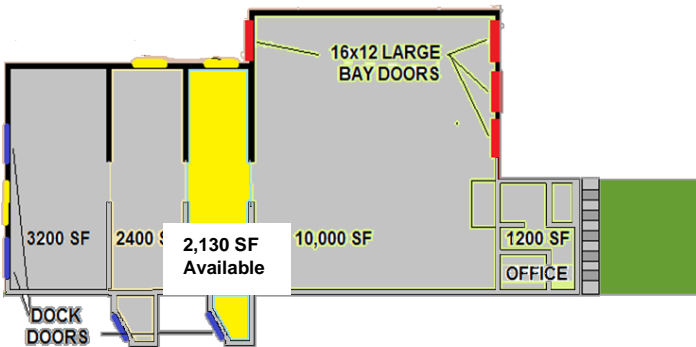

**2,130 SF TOTAL**

Property Features:

- 2,130 sf warehouse with 1 Dock door
- Located just off new highway 15 ramp with new light up sign in front giving great visibility!
- 20 ft ceilings
- Natural gas heating
- Former manufacturing facility fitted with several power options
- Ample parking

**Why Choose Us?**

- Flexible Leasing Options
- First Rate Customer Service
- Client Consulted Layouts
- Professional & Helpful Staff
- 24-7 Emergency Services
- Locally Owned & Operated
- Bilingual Service



Contact Cathy Sweet

506 869 0942

cathy@comztar.com

www.comztar.com

