

47 Industrial St., Dieppe, NB

2,130 SF AVAILABLE

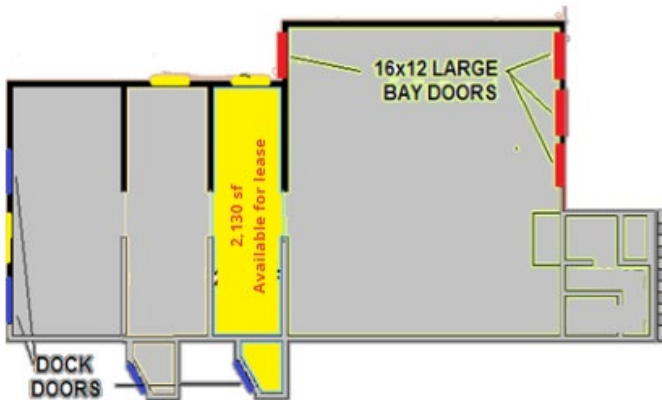

2,130 SF AVAILABLE

Property Features:

- 1 Dock door
- 20 ft ceilings
- Natural gas heating
- Former manufacturing facility fitted with several power options
- Located just off new highway 15 ramp with new light up sign in front giving great visibility!
- Big yard offering ample parking

Why Choose Us?

Flexible Leasing Options
First Rate Customer Service
Client Consulted Layouts
Professional & Helpful Staff
24-7 Emergency Services
Locally Owned & Operated
Bilingual Service



Contact Cathy Sweet

506 869 0942

cathy@comztar.com

www.comztar.com



@comztar



/comztar



/comztar